



## Smart Lock User Manual

Please read this manual carefully before installation

V3.0

## Usage Notice

**Note: Please prepare a Phillips screw driver and 4 AA batteries before installation. After installation, calibrating the lock and debugging must be operated first.**

- In default setting, it can be unlocked with original password '1234567890', any fingerprint or mechanical key.
- There will be a low power alarm when voltage below 4.8V, it can be only unlocked around 50 times, please replace with 4 new AA batteries in time. When batteries power running out, it can be unlocked by connecting a power bank with micro USB wire though emergency power port. Please note the APP network function will not work in this situation.
- Please don't use any corrodent material to clean lock surface.
- Please use mechanical key to unlock when the fingerprint, password and APP not work. Make sure your keys kept in outdoors safe place.
- Suitable door thickness: 35~55mm.
- Working temperature: -25°C~ 55°C.

## Features

- The fingerprint capacity is 50, the password capacity is 50, the first two users are administrators. Please input password as the first administrator.
- Automatically open and lock door.
- Support volume adjustment(Mute/Low/High) and low power alarm.
- Support 6-8 passwords and 16 virtual passwords.
- Indicator Light: White: Operate/Unlock successful. Red: Operate/Unlock failure.
- ⏪: Return or Quit. ⏹: Confirm or Lock.

Name	Parameter
Fingerprint Sensor	semiconductor
DPI	500
Identify Time	0.3S
Unlock Way	Fingerprint, Password, Key and APP
System Capacity	100
Supply Voltage	4.6V - 6.4V
Low Voltage Alarm	4.8V
Standby Current	<150uA

## Installation Overview

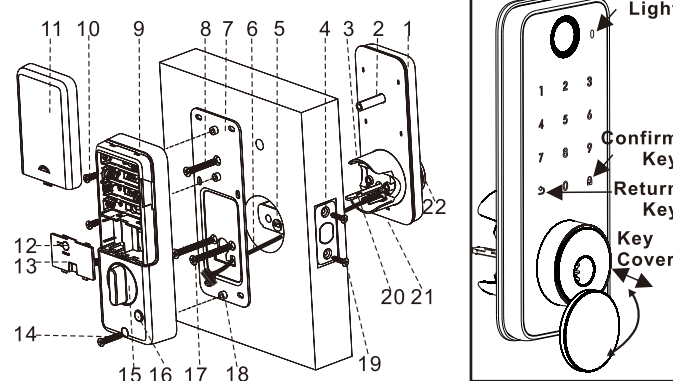

- Front Panel
- Connection Column(Standby)
- Front Panel Block
- Lock Body
- Pick Jack
- Connection Wire
- Iron Plate
- Connection Column Screw(M4\*37mm) (Standby)
- Back Panel
- Back Panel Screws(M4\*10mm)
- Battery Cover
- Reset Button
- Back Cover
- Back Panel Screw(M4\*25mm)
- KNOB
- Switch Button
- Front Panel Screws (M5\*45mm or 55mm)
- Convex Stud
- Tapping Screws (M4\*20mm)
- Paddle
- Emergency Power Port
- Key Cover

## Installation

### 1. Installation Instructions

- It is recommended professionals to install with reference installation video.
- While installing and commissioning, please stand in the room all the time.
- While installing the front panel, keep the logo up and pass the connection wire under the lock body, keep the bump of the paddle faces upwards and fits into the lock body.
- After the installation is completed, check whether the password '1234567890', fingerprint, APP, mechanical key, knob work ok or not.
- If it does not work properly, please check whether there has been an error installation or loose power cord connector during installation.

### 2. Open Hole

Please refer to the open hole drawing, and drill correct holes on the door.

#### Notes:

- The distance between door edge and lock body center can be 60mm or 70mm.
- The diameter of the open hole can be 38-54 mm.
- If the diameter of the door open hole is less than 52mm, the front panel block shall be removed.

### 3. Install Lock Body

- According to the central position of the open hole of the door, adjust the position of the pick jack of the lock body.
  - Hold the head of the lock body with your hand.
  - Turn the lock tail clockwise or counter-clockwise, adjust the position of the pick jack of the lock body to 60 mm or 70 mm.
  - Insert and turn the paddle to test whether the lock body switch is ok or not.
- The mark 'UP' face UP and fit the lock body.
- Twist 2 tapping screws.

### 4. Install Lock

#### 4.1 Install The Front Panel

- Pass the connection wire under the lock body. **Note: Do not pass the connection wire above the lock body.**

- Adjust the paddle to the horizontal direction, keep the bump of the paddle faces upwards and fits into the pick jack of the lock body.
- Fix the front panel on the outdoors.
- The iron plate is fixed on the inner side of the door through the connection wire so that the pick is centered.

**Note: 1. The convex stud face outward.**

**2. The door thickness is less than 39mm, one section of the paddle need be cut off.**

- Refer to the table below, select the corresponding front panel screws and fix it.

Door Thickness	Front Panel Screws
35-45mm	M5*45mm
45-55mm	M5*55mm

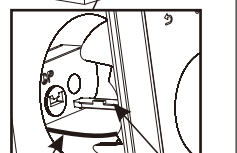
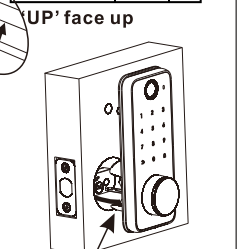
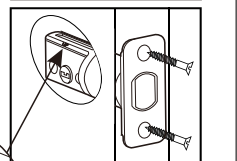
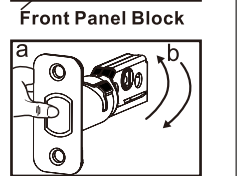
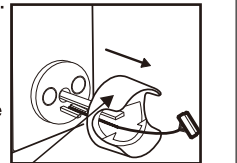
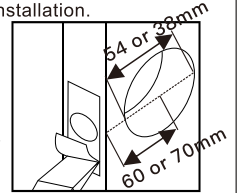

Connection Wire: Under Bump of the Paddle: Upward

- f. Adjust the front panel and the iron plate so that they are upright.  
g. The connection wire is wound into the slot on the right.

**Note: If you feel that the front lock is not fixed, you can remove the front panel and the iron plate. A round hole with a diameter of 20 mm is made on the door body from 77 mm above the center point of the door hole, Then use the standby connection column and connection column screw (M4\*37mm) to reinforce the fixing.**

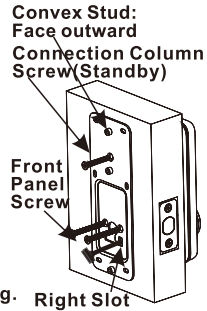

#### 4.2 Install The Back Panel

- a. Remove the back cover, pass the connection wire through the back panel, and straighten.  
b. Turn the **KNOB** to the vertical position and align the pick to the door.  
c. Turn the KNOB to check the latch switch is ok.  
d. Lock 2 back panel screws (M4\*10mm) and 1 back panel screw (M4\*25mm), shake the front and back panel to ensure the front and back panel is tight.  
e. Insert the connection wire interface into the back panel. The excess wire is hidden in the back cover frame. Install the back cover.  
f. Install 4 AA batteries and the battery cover.

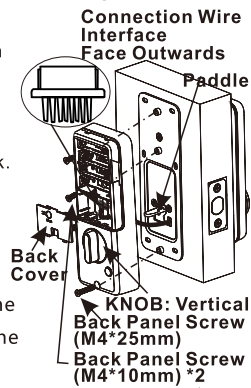

#### 5. Install Buckle Plate and Buckle Box

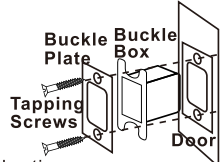

### Calibrating The Lock

- a. Please Stand in the room all the time when Calibrating.  
b. **Reset Lock:** Long press 'Reset' button for 3 seconds, restore to the factory default settings.  
c. **Calibrate the Door Open Direction:** When the voice prompt 'Di', the '↻' button is always bright, turn the KNOB from the vertical position to the horizontal position until the voice prompt 'successful'.  
**Note: If calibrate failure, the '↻' button is always bright, in the direction of rotation, turn the KNOB down hard 1-2 degrees.**  
d. **Calibrate the Door Close Position:** Close the door, and press '7' for 3 seconds, automatically calibrate the door close position.

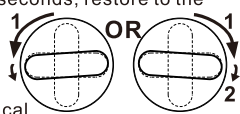

### Debugging

- a. Please Stand in the room all the time when debugging.  
b. **'↻' button:** Short press, the bolt stretch out;  
c. Fingerprint / Password Unlock, the bolt retract.  
d. **'Switch' button:** Short press, the bolt stretch out or retract.  
e. **KNOB:** Rotate, the bolt stretch out or retract.  
f. Any way fingerprint / password / 'switch' button / KNOB unlock, then close the door, the latch will stretch out to lock automatically.  
g. Verify other function includes Self-lock, Anti-peeping password, 'Reset' button, APP work well or not.

## Using The Lock

### Add Administrator (The first two users are administrators)

1. Press any key to wake up the screen and press '↻' for 3 seconds.
2. Add administrator password (6-8 digits) ended with '0'. (The same password, 2 times)
3. The voice prompt 'Successful', then we can continue to add the 2nd administrator.
4. Add administrator's fingerprint (6 times), or password (6-8 digits) ended with '0'. (The same password, 2 times).
5. The voice prompt 'The administrator is full, quit setting'.

**Note: Make sure to press different parts of the same finger until the whole finger is collected completely, the lock key '1-6' will be light on when add successful. The improper operation will increase the input times.**



### Add User

1. Press any key to wake up the screen and press '↻' for 3 seconds, the voice prompt 'Please verify administrator'.
2. Verify the administrator, and the voice prompt 'Successful, please add user'.
3. Add user's fingerprint (6 times), or password (6-8 digits) ended with '0'. (The same password, 2 times). The voice prompt 'Successful'.

### Delete User

1. Press any key to wake up the screen and press '↻' for 3 seconds, the voice prompt 'Please verify administrator'.
2. Verify the administrator, and the voice prompt 'Successful, please add user'.
3. Press '↻' for 3 seconds again.
4. Press '1' to delete all user fingerprints, press '2' to delete all user passwords, press '3' to delete all users. The voice prompts 'Successful'.

**Note: The administrator can not be removed by doing this or by APP. Only resetting the lock can delete the administrator.**

### Modify Password

1. Press '5' for 3 seconds, the voice prompt 'Please input old password'.
  2. Enter the old password which needs to be modified, the voice prompt 'New password'.
  3. Enter new password (6-8 digits) ended with '0', the voice prompt 'Successful'.
- Note: The previous password is invalid after modification. The administrator password cannot be modified.**

### Reset Lock

1. Press 'Reset' button of the back panel for 3 seconds, the button light flashes.
2. Verify the administrator, and the system restores to the factory default settings. (The initial password is '1234567890')
3. After the reset, all the information are removed (including the administrator).
4. Please calibrate the lock first and add a new administrator immediately.

### APP Installation and Network Configuration

(Make sure you add administrator before network configuration)

1. Search **Omki** in APP store, download APP.
2. Install and open APP, register and login with the mobile phone number.
3. APP: Press 'Home' / 'Add Device' / 'Security & Sensor' / 'Lock (Wi-Fi)' / 'Confirm indicator rapidly blink', then select WiFi network, enter WiFi password.
4. Lock: Press '3' for 3 seconds, Verify the administrator, the indicator light will flash.
5. APP: Refer to the operation prompt to complete the network configuration.
6. Add successfully, the voice prompt 'Successfully'. If it is failure, please try again.

#### Notes:

1. This APP supports only 2.4Ghz WiFi network.
2. The WiFi connected to the APP and mobile phone should be stay in same.
3. **APP Remote Unlock:** Press '4' for 3 seconds on the door lock to activate, then press the Lock Icon in APP to unlock.
4. **Remote Dynamic Password:** Click the dynamic page to get the dynamic password which valid within 5 minutes.  
**Unlock:** Press '2' for 3 seconds, when the voice prompt 'Di', enter dynamic password ended with '0' to unlock.
5. **Temporary Password:** Click 'Temporary PW' / 'Add' to get temporary password.  
**Unlock:** Press '6' for 3 seconds, when the voice prompt 'Di', enter temporary password ended with '0' to unlock.

### Other Function

**Self-lock of The Password:** It will be locked 180 seconds when entering wrong password 5 times continuously.

**Release Self-lock:** Unlock with registered fingerprint once.

**Self-lock of The Fingerprint:** It will be locked 180 seconds when entering wrong fingerprint 5 times continuously.

**Release Self-lock:** Unlock with registered password once.

**Low Power Alarm:** When the battery power is lower than 4.8V, the lock will prompt 'The battery is use up, please replace it', please replace with 4 new batteries in time.

**Anti-peeping Password:** Random password added before or after the correct password, it also can unlock as long as the real password keep continuously correct. (Anti-peeping password can not exceed 16 digits)

**Volume Switch:** Press '3330', you can switch the volume (Mute/Low/High).

**Regularly Open Mode:** After administrator unlocked, the light of '5' '8' will be on, press '5' '8' now, the lock will be set in regularly open mode.

**Release Regularly Open Mode:** Unlock with administrator once.

**Correct the Door Close Position:** Close the door, press '7' for 3 seconds, Verify the administrator, automatically correct the door close position.

## FCC Statement:

### FCC ID: 2AXH7-Q106

This device complies with Part 15 of the FCC Rules. Operation is subject to the following two conditions:

- (1) This device may not cause harmful interference.
- (2) This device must accept any interference received, including interference that may cause undesired operation.

**Warning:** Changes or modifications not expressly approved by the party responsible for compliance could void the user's authority to operate the equipment.

**Note:** This equipment has been tested and found to comply with the limits for a Class B digital device, pursuant to Part 15 of the FCC Rules. These limits are designed to provide reasonable protection against harmful interference in a residential installation. This equipment generates uses and can radiate radio frequency energy and, if not installed and used in accordance with the instructions, may cause harmful interference to radio communications. However, there is no guarantee that interference will not occur in a particular installation. If this equipment does cause harmful interference to radio or television reception, which can be determined by turning the equipment off and on, the user is encouraged to try to correct the interference by one or more of the following measures:

- Reorient or relocate the receiving antenna.
- Increase the separation between the equipment and receiver.
- Connect the equipment into an outlet on a circuit different from that to which the receiver is connected.
- Consult the dealer or an experienced radio/TV technician for help.

## FCC Radiation Exposure Statement:

This equipment complies with FCC radiation exposure limits set forth for an uncontrolled environment. This equipment should be installed and operated with minimum distance 20cm between the radiator & your body.



APP Download QR Code